

An Ecology of Presence



2024.11.14



“Blessed to be a blessing”



Genesis 12:2-3



“Hate evil. Love good. Work it out in the public square.”



Amos 5:15 (MSG)

The Model

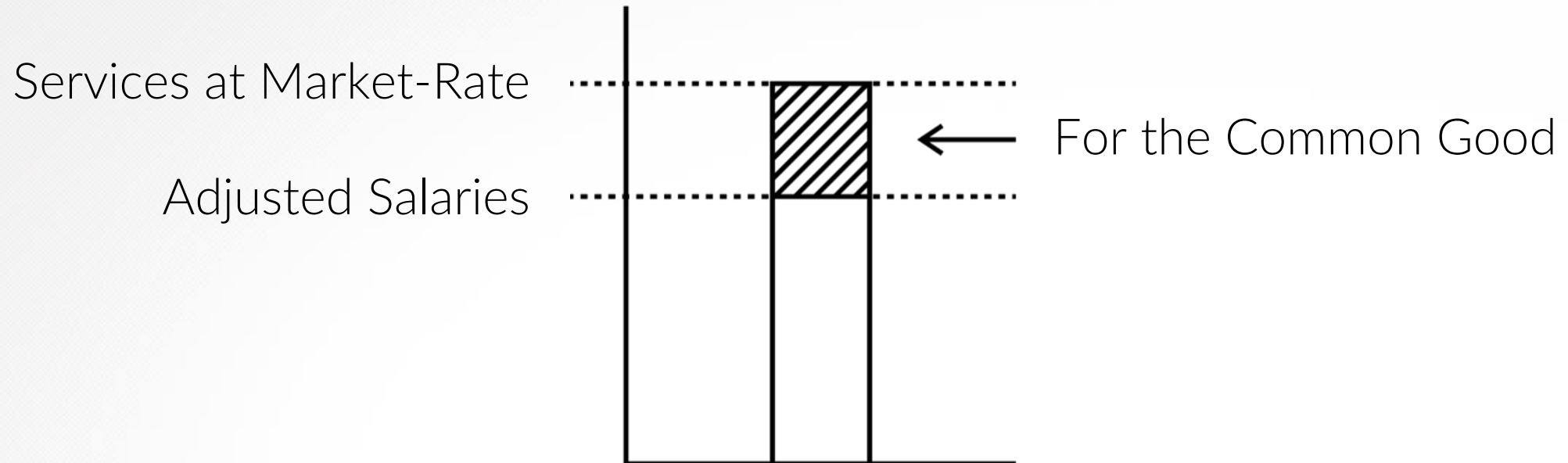

“Isaiah 40” Smooth Curve

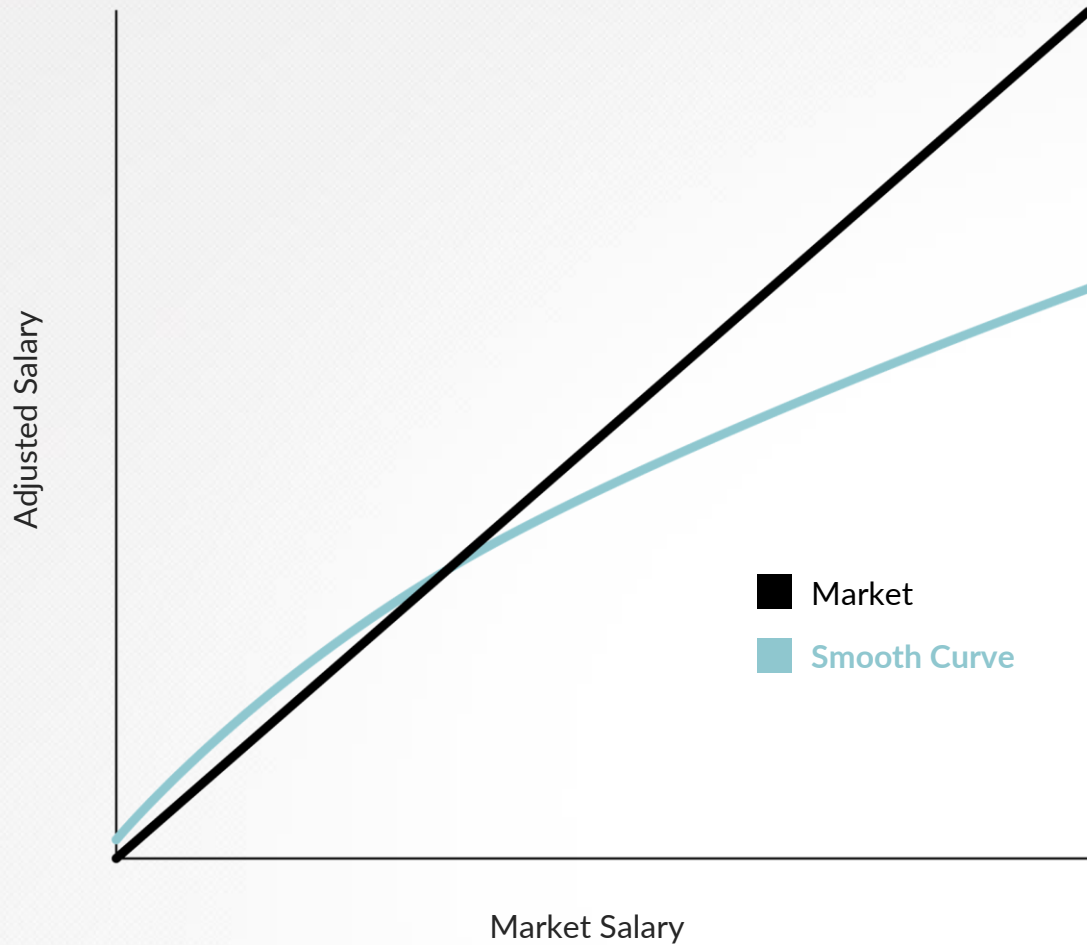

Dedicated to Common Good

5% TIME

10% PROFIT

100% EQUITY

Our Neighborhood: **Bayview-Hunters Point**

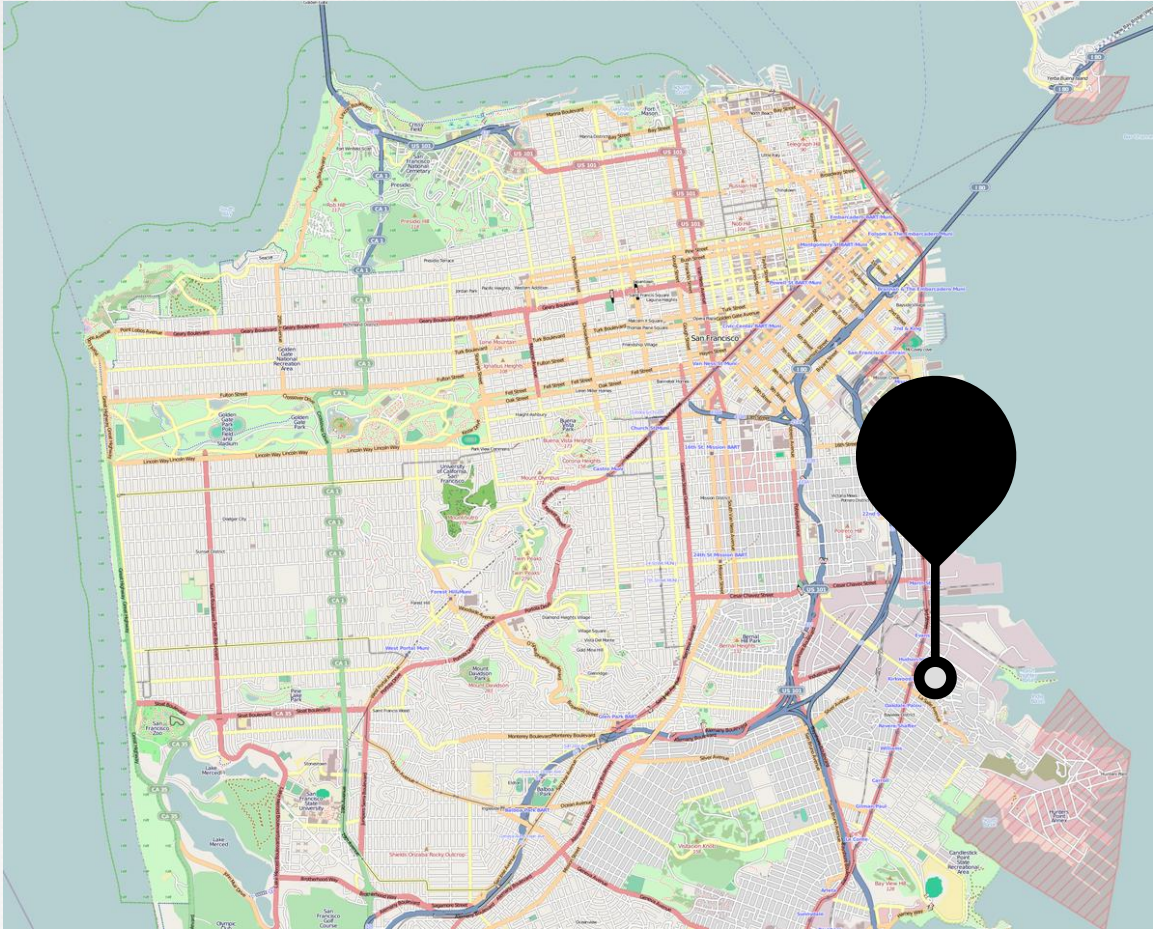

African American Arts and Cultural District

COMMUNITY OF 40,000

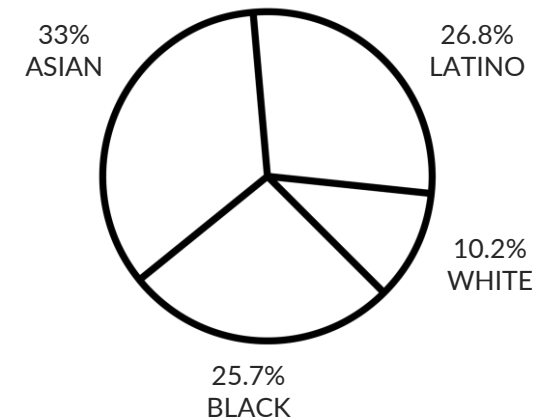

Our Neighborhood: **Bayview-Hunters Point**

People Living Below the Federal Poverty Line

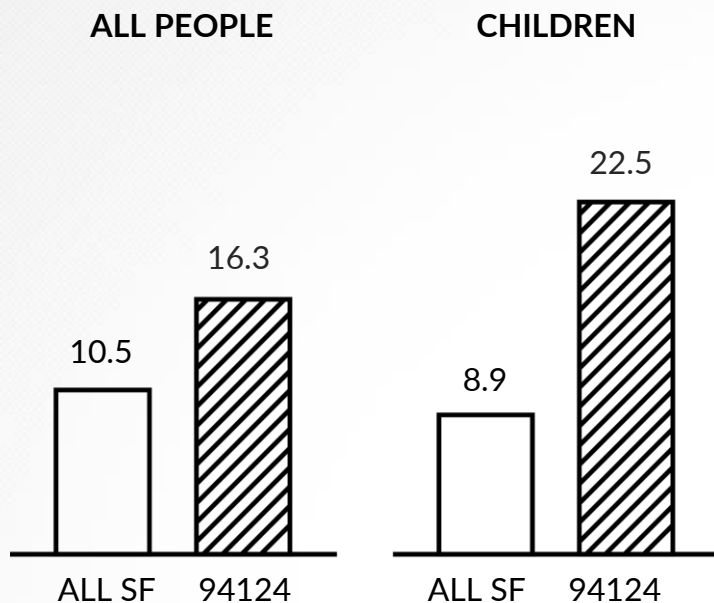

Education

Of those 25 years of age or over:

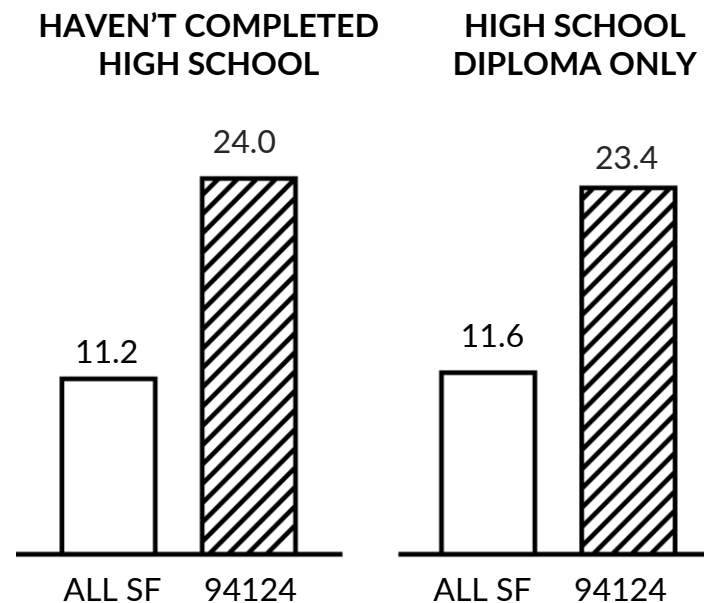



Experiencing welcome: **the Church in Bayview**



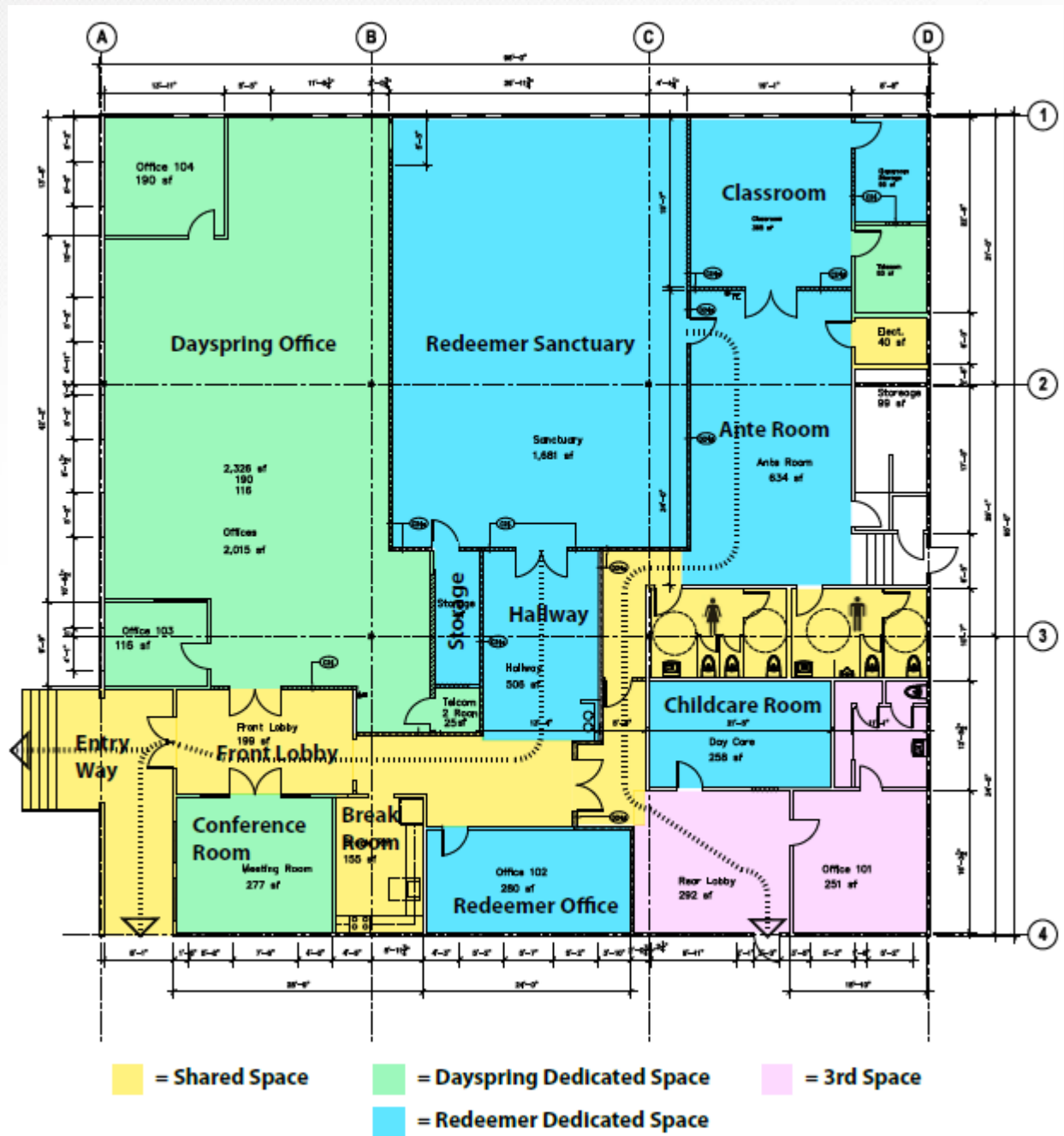

2013: Sabbatical Wanderings





2013: Luke 10 *Lectio*

Luke 10 After this the Lord appointed seventy-two^[a] others and sent them on ahead of him in pairs to every town and place where he himself intended to go. ² He said to them, “The harvest is plentiful, but the laborers are few; therefore ask the Lord of the harvest to send out laborers into his harvest. ³ Go on your way; I am sending you out like lambs into the midst of wolves. ⁴ Carry no purse, no bag, no sandals, and greet no one on the road. ⁵ Whatever house you enter, first say, ‘Peace to this house!’ ⁶ And if a person of peace is there, your peace will rest on that person, but if not, it will return to you. ⁷ Remain in the same house, eating and drinking whatever they provide, for the laborer deserves to be paid. Do not move about from house to house. ⁸ Whenever you enter a town and its people welcome you, eat what is set before you; ⁹ cure the sick who are there, and say to them, ‘The kingdom of God has come near to you.’^[b] ¹⁰ But whenever you enter a town and they do not welcome you, go out into its streets and say, ¹¹ ‘Even the dust of your town that clings to our feet, we wipe off in protest against you. Yet know this: the kingdom of God has come near.’^[c] ¹² I tell you, on that day it will be more tolerable for Sodom than for that town.



"He Sent them out Two by Two/Il les envoya deux à deux" (1886-1896), by James Tissot (1836-1902). Brooklyn Museum. Public Domain.

"Leveraging privilege" vs. Luke 10 vulnerability

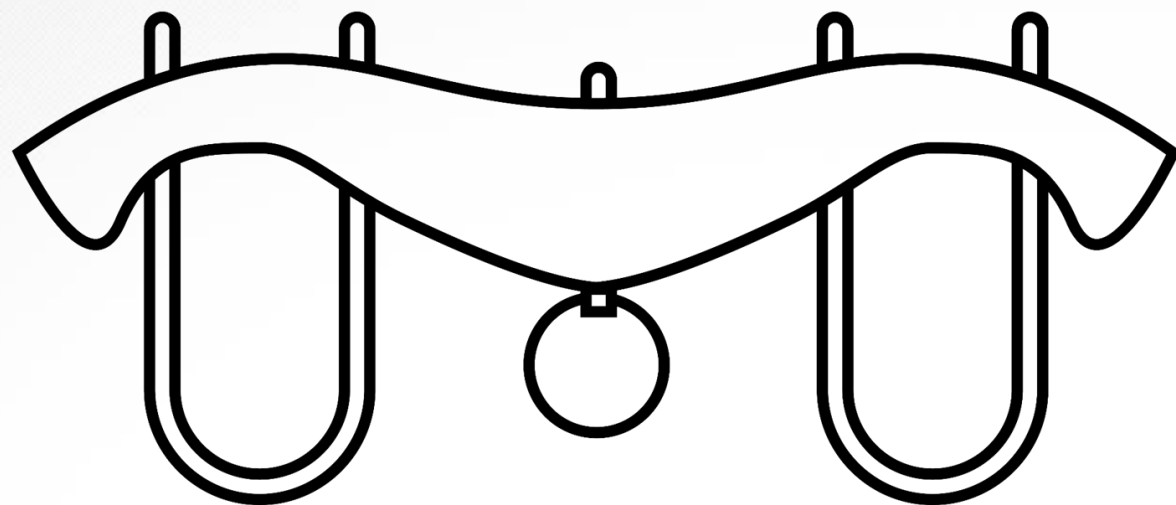

“So that through the church, the wisdom of God in its rich variety might now be made known to the rulers and authorities in the heavenly places”

Ephesians 3:10



NEIGHBOR FUND

Lending as a practice of peace.

Relational Lending

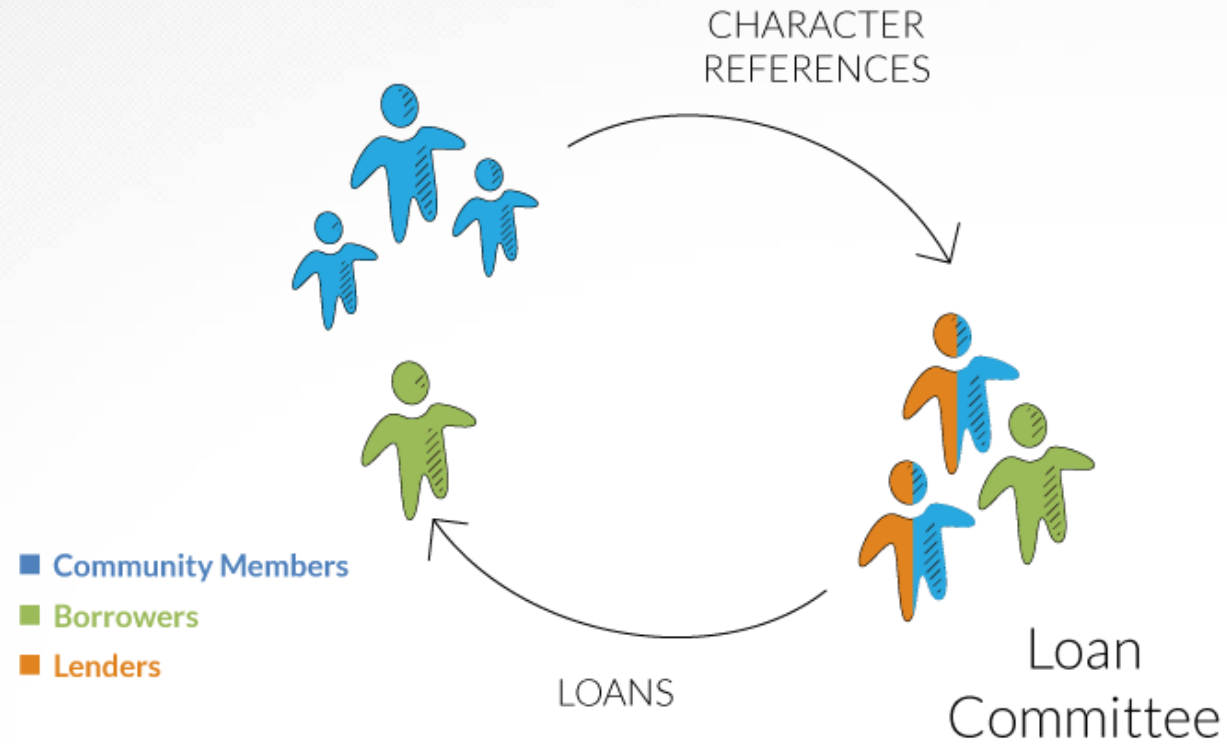





“Inspiring young scholars to reason,
create, serve, and lead”



80% of scholars are first-gen, low-income, or Bayview
residents

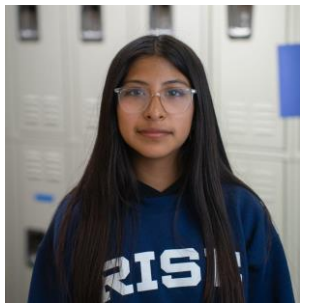

Finance. Facilities. Formation.



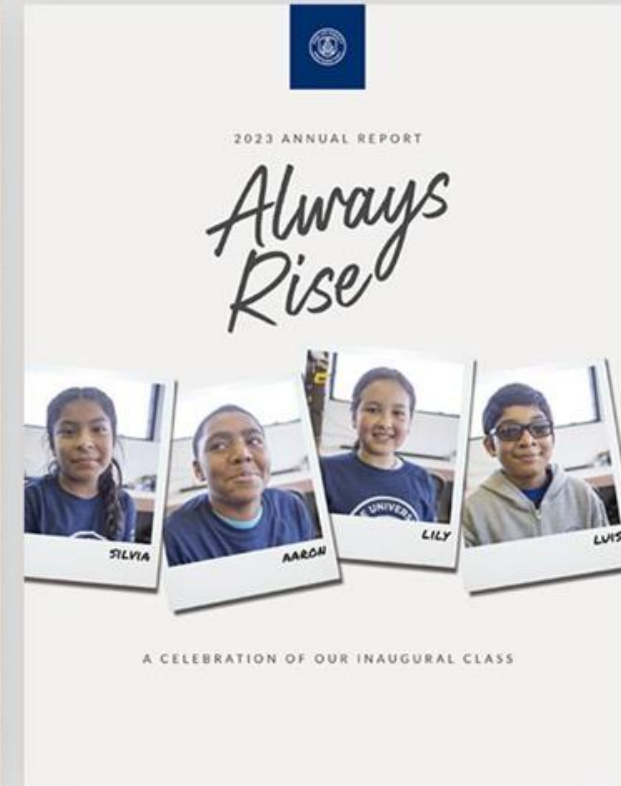
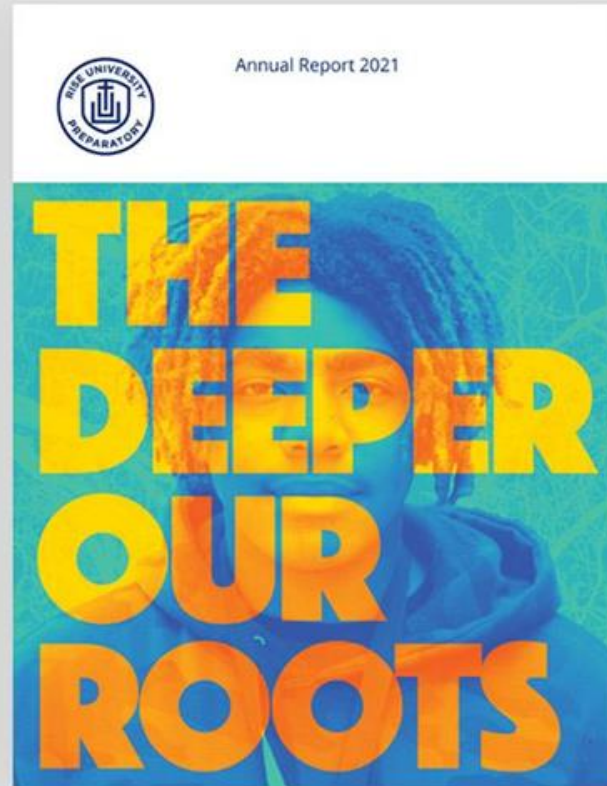
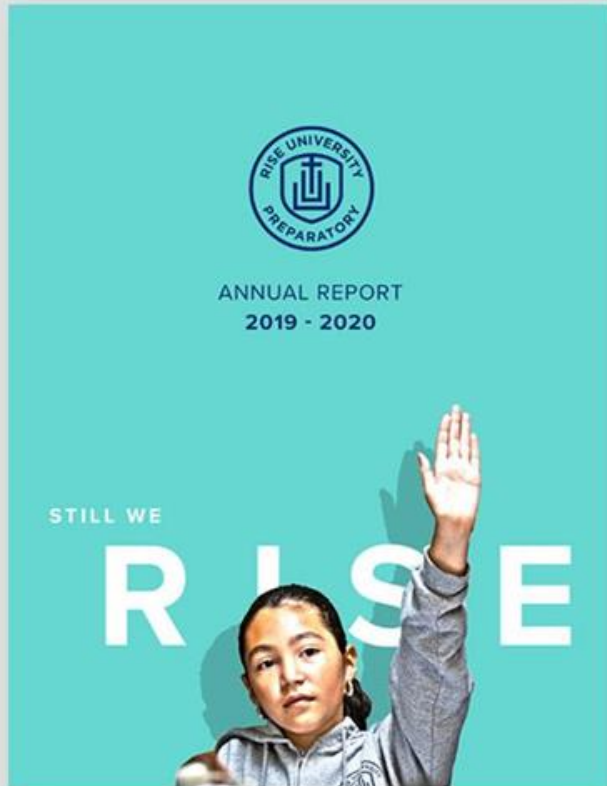





Curriculum and
Program Support

Financial Support

Friendship &
Mentoring





Rise Prep Class of 2024

“Now to him who by the power at work within us is able to accomplish abundantly far more than all we can ask or imagine...”

Ephesians 3:20



Academic Growth

The inaugural Class of 2024 made great gains in math and reading over their first 6 years at Rise.

80%

ABOVE NATIONAL AVERAGE
IN **MATH** BY 11TH GRADE

+30% FROM 6TH GRADE

90%

ABOVE NATIONAL AVERAGE
IN **READING** BY 11TH GRADE

+50% FROM 6TH GRADE



Eligible for California 4-Year Universities



All California



SF Unified
Latino



SF Unified
African American



Rise Prep
Class of 2024



Accepted into 4-year universities



Rise Prep
Class of 2024



RISE

“...to him be glory in the church
and in Christ Jesus throughout
all generations”

Why an **ecology** of presence?



REDEEMER



Dayspring
Partners



“The Word became flesh
and moved into the
neighborhood”

John 1:14 (MSG)

A Venn diagram consisting of three overlapping circles. The top circle is light blue, the bottom-left circle is light red, and the bottom-right circle is light green. The text is centered within the diagram.

Why an ecology of **presence**?

The nature of this presence

Vulnerable
Patient
Faithful

leaves space for **God's** activity

Table Discussion Questions

Where have you found welcome in your neighborhoods? In what ways have you seen the fruit of a posture of vulnerability? Or how might you explore this posture?

In what ways have you seen God accomplish abundantly far more than you can ask or imagine?



Chi-Ming Chien

Co-Founder, Dayspring Partners
Elder, Redeemer



Karen L. Yee, DDS

Elder, Redeemer



Victor Ho

Member, Redeemer
Board Member, Rise Prep



Tim Cahill

Vice Principal, Admissions Director
Rise University Preparatory



Amy Mar

Manager, Finance & Admin
Dayspring Partners



Andrew Lee

Engineer
Dayspring Partners